

ECO ALERT ■ Alarm window handle with climate function

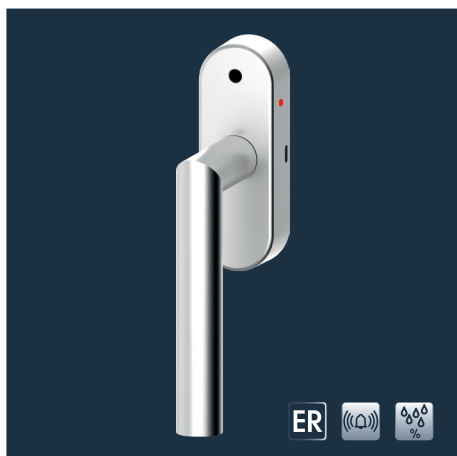

FO-310 AK

The innovative and high-quality FO-310 AK combines the standard turn-and-tilt function with an independent alarm and climate function. Simple to use with 90° ball bearing detent suitable for objects.

- Ideal for retrofitting to windows and patio doors
- No mains connection
- Alarm function with 115 dB(A)
- Incl. fixing screws and battery
- Climate function 50, 55 and 60% relative air humidity

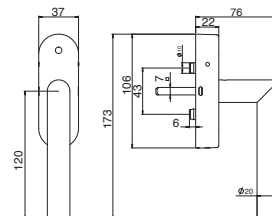

FO-310 AK CL-shaped	Material	Cams	Measured spindle length (L)*	Spindle length FO-310 AK	Art. no.
FO-310 AK ER	Stainless steel, matt brushed	∅ 10 mm / 12 mm	30 - 34 mm	32 mm	5030041746
FO-310 AK ER	Stainless steel, matt brushed	∅ 10 mm / 12 mm	35 - 40 mm	37 mm	5030041747

Product information

■ Your home made safer

Broken glass and windows levered open are the most frequent cases of burglary attempts through windows. This is where the alarm handle proves its strengths. Thanks to the integrated 3D sensor, it detects every movement of the window. Feel safer!

■ Alarm function

The 3D sensor integrated in the window handle detects movement and vibration patterns typical of break-in attempts, and responds by sounding a 115 dB(A) loud alarm signal for three minutes (similar to a smoke detector).

■ Prevent mould

Mould is a nightmare in any home. To prevent it forming in the first place, the alarm handle indicates if the indoor climate is in a critical range – before anyone notices. Air your rooms properly!

■ No mains connection necessary

The alarm handle is quickly fitted, easy to set and can be operated independently of the mains using a standard battery (1/2 AA 3.6 V), which lasts for up to two years. Acoustic signal warns of low battery charge.

■ Simple retrofitting for both existing and new buildings

The alarm handle is available in three different pin lengths and is thus ideal for existing buildings, new buildings and as a replacement for your current window handles. All you need is a screwdriver.

■ Elegant design

Timeless sophistication meets innovative technology. The stainless steel window handle is completely independent of the mains supply. Each and every window handle is a stand-alone system without any complex control units.



On account of its sensitivity, an ECO ALERT alarm window handle can also monitor multiple-casement windows. To guarantee a uniform appearance, we also supply window handles without alarm and climate function in the same high-grade design.



Which spindle length do I need?
Unscrew your old window handle and measure the protruding spindle length (L)* of the square spindle in mm (see table above).

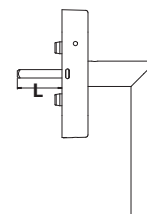

Product information and use of ECO fitting technology

§ 1 Product information and intended use

1. The fitting systems made by ECO are assistive systems that can be used to help with opening and closing motions and/or locking processes for doors, glass doors and window elements.
2. The fixing elements supplied with these products must be used and installed according to the mounting instructions/specifications.

§ 2 Improper use of the products

Improper use of fitting systems for doors and windows (i.e. not using the product as intended) includes the following situations in particular:

- Installation or mounting of foreign objects and/or objects not intended for this purpose into the fitting system;
- Using auxiliary tools to operate the system;
- The fittings are used as a replacement for a missing wall buffer;
- Fittings are misused as a suspension device for heavy loads;
- Fittings are used long-term in combination with panic locks instead of only in emergencies, against the recommendation of the lock and fitting industry;
- Surface of the fitting systems damaged by the use of sharp or hard objects;
- The usage of fixing elements made by third-party manufacturers.

Sooner or later, these errors will cause damage, and the products will no longer have the characteristics defined by the manufacturer.

§ 3 Product performance

1. Product performance is only partially governed by standards. Many aspects of product performance have been developed based on years of experience and should be considered common knowledge in the construction hardware industry. Correspondingly, the contents of these standards and these empirical values should also be applied to fittings that are not expressly regulated.
2. Specifically, the following standards apply:
 - EN 1906: General benchmarks for door fittings and accessories;
 - DIN 18273: Special rules for fire and smoke control doors;
 - DIN 18257: Minimum security requirements for security fittings.
3. The fitting system must be replaced if, despite maintenance and servicing, it can no longer be ensured that it will function properly, and/or it may pose a risk of injury.
4. Furthermore, the products are continuously being improved, and manufacturing is subject to quality assurance. The right to make technical changes is reserved.

§ 4 Product maintenance

1. The user must ensure that the fitting systems and fixing elements are installed in a proper functional manner.
2. Depending on the material and where they are used, the products will face a certain degree of natural wear and tear. Consequently, all moving parts must undergo maintenance at least once per year; i.e. the proper fit, stability of the screw connections, etc. must be checked on a regular basis. Only water, gentle cleaning agents and other cleaning agents that do not contain corrosive ingredients should be used for cleaning the fitting systems.
3. Manufacturing primarily uses the materials nylon, aluminium, stainless steel and brass. Please note that each of these different materials has different maintenance and servicing requirements.

§ 5 Duty to inform and instruct

1. The following documents are available to provide information and instruction:
 - Catalogues and brochures;
 - Tender documents;
 - Procurement information;
 - Bid documents;
 - Installation and operating instructions;
 - DIN standards.
2. In order to ensure that the fitting systems function properly:
 - Architects, planners and any other people involved in the process are required to request all the necessary product information from us and to comply with said information,
 - Specialised retailers are required to observe the product information and notes in the price lists and catalogues and, in particular, to request all required instructions from us and to pass them on to the processors,
 - The processors are required to obtain all product information and to comply with it, and, in particular, to request the operating and maintenance instructions from us and pass them on to the customers and users.

Overall, all parties involved must ensure that the fitting systems are properly assembled and installed and that each end user receives proper instructions and explanations.



ECO

ECO General information

ECO recommends:

- For lever handle sets without a return spring, we recommend using locks that comply with **DIN 18251**- class 3 or higher.
- In order to minimise the clearance between the lever handle set and the lock, we recommend locks that comply with **DIN 18251** with a clamping nut.
- When ECO fittings are properly installed and used, the paint should withstand daily use. Excessive contact with hard or sharp objects (such as key rings, rings, etc.) can scratch the surface. This does not impact the functionality, however.

ECO Schulte GmbH & Co. KG

Iserlohner Landstraße 89

D-58706 Menden

Telephone +49 2373 9276 - 0

Telefax +49 2373 9276 - 40

info@eco-schulte.de

www.eco-schulte.de

Our compendium represents a compilation of all products from our range of services. These are subject to different delivery classes. Special variants included are often manufactured to customer specifications and sometimes require longer delivery times and minimum purchase quantities. Further advise can be given by your contact person.

■ SYSTEM TECHNOLOGY FOR THE DOOR

